

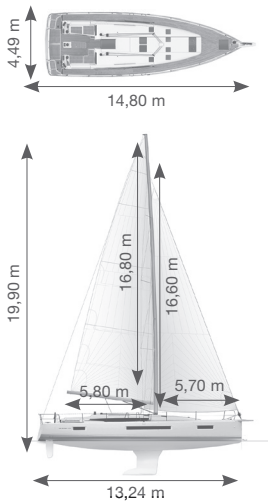

Sun Odyssey 490

SPECIFICATIONS



Overall length	14,42 m / 47'3"
Overall Length with Bowsprit	14,80 m / 48'6"
Hull length	14,00 m / 45'11"
Waterline length	13,24 m / 43'5"
Beam	4,49 m / 14'8"
Displacement light load with deep draft keel	11290 kg / 24890 lbs*
Standard keel draft	2,24 m / 7'4"
Standard keel weight	2870 kg / 6327 lbs*
Shoal keel draft	1,65 m / 5'4"
Shoal keel weight	3213 kg / 7083 lbs*
CE category 2-3 cabin layout	A9 / B10 / C14*

CE category 4-5 cabin layout	A13 / B14 / C16*
Fuel capacity	240 L / 63 US gal
Water capacity	640 L / 169 US gal
Fridge capacity	190 L / 50 US gal
Holding tank capacity	130 L / 34 US gal
Architect / Designer	Philippe Briand Piaton Bonet Yacht Design Jeanneau Design
Standard mainsail, horizontally-cut, in Polyester "High Strength"	56,80 m² / 611 Sq ft
Standard 125% headsail, horizontal-cut, in Polyester "High Strength"	53,60 m² / 577 Sq ft

**Provisory, certification under progress*

AN EXCEPTIONAL LEVEL OF EQUIPMENT

EXTERIOR

Sailing features

- High aspect ratio rig, cathedral mast and split rigging
- Harken genoa tracks
- Harken roof and primary winches
- Harken deck hardware
- Anodised aluminium mast and boom
- Boom with rigid boom vang and lowered gooseneck, to ease manoeuvring
- Battened mainsail. Furling genoa with UV protection
- Discontinuous standing rigging, stainless steel wire
- Lazy bag and lazy jacks
- Sheets lead back to the helm – German sheeting
- Large choice of sails sets and optional performance mast

Construction

- Infused sandwich hull with balsa core and fiberglass skins, ISO gelcoat surface, protective barrier coat
- Infused fiberglass inner liner, easy access to grounding frame, relamination in stays attachment areas.
- Prisma Process® injected deck, ISO gelcoat, discontinuous balsa block coring – 30% weight savings as compared to traditional decks
- Twin rudders with self-aligning roller bearings

Cockpit

- Asymmetrical cockpit with dedicated area for dining, lounging and manoeuvring
- Walk-in access to side decks, enabling to walk around the deck without crossing any steps.
- Multi-function cockpit table
- Leather-covered stainless steel steering wheels
- Large aft fold-down swim platform with telescopic ladder
- Hinged companionway doors

Deck

- Easy circulation thanks to the inclined side decks
- Flush deck hatches
- Long tinted acrylic roof windows
- Split rigging: Inboard shrouds for easier access forward
- External woodwork and inlays made of teak
- Mid-ship cleats
- Electric windlass

INTERIOR

- One-level interior with no door sills
- Large doors, double access to aft head
- Leather-wrapped handrails
- LED lighting
- Large, rectangular double berths
- Fully-upholstered hull sides
- Blinds for each hatch and opening in the forward and aft cabins
- Numerous choices of interior ambiances
- Large seaworthy storage spaces, with fiddles. Soft closing drawers and cabinets
- Separated shower compartment in the forward owner's cabin
- Full-size mirrors in the owner's cabin and in the heads

Chart table

- Large navigation desk with leatherette lining and interior storage for a portable computer, electrical panel, sofa and wide books storage

Galley

- U-shape galley, ideally located near the centre of gravity of the boat
- Corian® countertops

- Double stainless steel sinks
- 2-burner stove with oven
- Fridge 130 L / 34 US gal with top access to better maintain the cold air

Woodwork

- Woodwork in alpi® Teak or Grey Cedar
- UV stabilized varnish
- Laminate floorboard in Ceruse Oak colour
- Numerous solid wood mouldings

TECHNICAL

Electrical

- LED navigation and anchoring lights
- 12V electrical panel
- Battery Exide Dual Marine
- 125A alternator and charge distributor/isolator
- Positive and negative battery cut-off switches to better protect battery banks

Water System

- Hot and cold cockpit shower
- Hot water heater 40L/ 11US gal
- "Heavy-duty" water pump

Engine

- Latest-generation Common Rail engine with reduced CO₂ emissions and consumption
- Sail Drive
- Fixed 3-blade propeller
- Sound insulation 40 mm / 1 1/2" thick, with fire retardant film

TRIM LEVELS AND PACKAGE

TRIM LEVEL	PREMIERE	PREFERENCE
	A, B, C	A, B
Layout applicable		
GRP bowsprit with integrated anchor roller (replaces the standard anchor roller)	✓	✓
Second windlass control with chain counter, installed in the cockpit	✓	✓
Halyard bags in the cockpit with stainless steel frame (3)	✓	✓
40 amp battery charger for 12V battery banks	✓	✓
Additional service batteries 2 X 115 A/H	✓	✓
LED courtaisy lighting in the cockpit	✓	✓
3 burner cooker and oven with grill function (replaces standard 2 burner cooker)	✓	✓
Protective GRP eyebrow for the long acrylic roof windows	✓	✓
Navicolor battery monitoring	✓	✓
Upholstered bulkheads		✓
Indirect led lighting, and lamps on bulkheads		✓
Sound deadening lining in cabinets		✓
Shades for windows and ports in the saloon		✓
Shades and screens for hatches in the saloon		✓
Signature clock and barometer set at the chart table		✓
Wine storage locker under floorboards		✓
Specific compartment for cutlery in the central galley storage unit		✓

PERFORMANCE VERSION (only for versions A and B)

- Tall anodised mast with 2 spreader, cathedral geometry and split rigging
- Dyform standing rigging
- Performance full batten mainsail, triradial cut, in grey x-grid mylar taffeta 62,68 m² / 674 sq ft
- 125% performance genoa, triradial cut, in grey x-grid mylar taffeta with uv protection 58,82m² / 633 sq ft
- Downwind package
- Harken ball-bearing genoa lead cars and control lines lead to cockpit
- Dyneema® low-stretch halyards and sheets for main and genoa
- Hydraulic textile adjustable backstay
- Composite steering wheels

DOWNWIND PACKAGE

- Spinnaker rigging with spinlock jammers
- Halyards and sheet for asymmetrical spinnaker / code 0 (2 polyester halyards, 1 sheet and 1 tack line in dyneema®, pulleys on mast step and side decks)
- Extra harken 46.2st winch to starboard on coachroof
- Extra winch handle
- Windex 15" on mast head

CONVERTIBLE COCKPIT PACKAGE

- Extending coamings convertible into lounging area
- Cushions for cockpit and sunbathing areas - oyster
- Starboard infill cushion for l-seating area

EXTERNAL GALLEY PACKAGE

- Safire portable bbq grill in the cockpit
- Cockpit sink with hot & cold water
- Portable 12v fridge in the cockpit table

PACK VOYAGER (only for versions A and B)

- High transparency sprayhood with led lighting-oyster
- Outboard engine bracket
- Releasable forestay + deck fittings
- Solar panel on coachroof with charging relay
- Seawater / freshwater foot pump in the galley

PACK ENTERTAINMENT AUDIO

- Ra70n fusion player (radio/usb/bluetooth/...)
- Bose® speakers in the saloon
- Bose® subwoofer
- Speakers in the cockpit

PACK ENTERTAINMENT VIDEO (only for versions A and B)

- DVD player Fusion MS-AV750 (cd / dvd / usb / bluetooth...) at the chart table
- Bose® speakers in the saloon
- Bose® subwoofer
- Speakers in the cockpit
- TV LED 32" in the saloon
- DVD player Fusion MS-AV750 (cd / dvd / usb / bluetooth...) in the forward owner's cabin
- TV LED 22" in the forward owner's cabin
- TV antenna for in mast fitting

EQUIPMENT

ARCHITECTURE

- Full-length hull chine for improved stability and speed
- Long waterline for better speed while sailing and under power
- L-shaped cast iron keel less exposed to seaweed and lines
- Twin rudders with self-aligning roller bearings

SAILS

Standard

- Horizontally-cut in Polyester "High Strength"
- Semi-battened main sail with 3 reefs 56.80 m² / 611 Sq ft
- 125 %furling genoa with UV protection 53.60 m² / 577 Sq ft

Options

- In mast furling main sail horizontally-cut in Polyester "High Strength" 45.22 m² / 487 Sq ft
- Self-tacking jib with UV protection in polyester "High Strength" 37.82 m² / 407 Sq ft
- Code 0 in triradial cross cut mylar/aramid laminate 92.50 m² / 995 Sq f with continuous line furler
- Code 0 in triradial cross cut mylar/aramid lam nate for performance mast 102.98 m² / 1108 Sq ft with continuous line furler

SAIL HANDLING

Standard

- Mainsheet attached to Dyneema® bridle forward of companionway, with sheets led back to the cockpit winches
- Harken genoa tracks with adjustable lead cars
- Spinlock jammers
- Coachroof winch 1 x Harken 46.2ST to port
- Genoa winches 2 x Harken 50.2 self-tailing winches for easy use at the helm stations
- Harken winch handle

Options

- Self tacking jib ball bearing track on coachroof
- Electrical coachroof winch Harken 46.2ST
- 2 x electrical primary winches Harken 50.2 ST

MAST AND RIGGING

Standard

- Classic aluminium mast with double spreaders, deck-stepped, cathedral geometry and split rigging
- Aluminium boom with rigid vang and lowered goose neck for easier handling
- Double backstay
- Genoa furler with double slot, furling line lead aft to cockpit on coach roof
- Running rigging topping lift, mainsail halyard, genoa halyard, mainsheet, genoa sheets in polyester
- Standing rigging discontinuous 1x19 stainless steel wire
- Asymmetrical lazy bag with integrated lazy jacks

Option

- Furling mast aluminium with double spreaders, deck-stepped, cathedral geometry and split rigging

COCKPIT

Standard

- Walk-in access to side decks, enabling to walk around the deck without crossing any steps.
- Large cockpit table with compass, cup holders, area for navigation instrument, cockpit light switch, LED lighting, bottle storage and optional portable fridge
- Teak inlay on bench seats, helms stations and transom platform
- Fixed coaming with ideal height for comfort and safety
- Cockpit lockers: 1 on starboard side, 1 on port side (versions B, C and D only), 1 large locker on the cockpit floor that can be used for the optional generator, one liferaft locker with open access to transom platform 92 x 65 x 48 cm (3' x 2'1" x 1'6")
- Universal gas box, cut-off valve under the stove
- Wheels with leather wrap, space for flush mounted GPS at each helm, stainless steel handrail, cup holders
- Emergency tiller, and fitting in cockpit floor
- Engine control: throttle lever at starboard helmstation and oriented engine panel on the cockpit table
- Large bathing platform with telescopic ladder
- Hinged companionway doors in plexiglas
- Sliding horizontal hatch in plexiglas

Options

- Cockpit table with wooden leaves: replaces the standard table with all the same functions
- Teak inlay on cockpit floor
- Large cockpit sprayhood, Sunbrella® Oyster, high transparency windscreen and LED cockpit lighting
- Cockpit Bimini with stainless steel bows in Sunbrella® Oyster, connecting fabric between Bimini and sprayhood
- Cockpit enclosure kit in Sunbrella® Oyster, fitted on the sprayhood and bimini
- Electrical bathing platform system with remote

DECK HARDWARE

Standard

- Bow pulpit in stainless steel
- Stern pushpits in stainless steel with buoy bracket and emergency ladder
- Lifelines double level of stainless steel lifelines
- Mooring cleats: 6 x aluminium
- Stainless steel handrails on coachroof (2)
- Deep anchor locker
- Electric 12V windlass 1000W - 10mm chain
- Long fixed tinted windows along coach roof
- Fixed cockpit windows in the aft cabins (2)
- Large, fixed hull ports (6)
- Opening ports in the roof (4)
- Opening deck flush hatches (11)
- Opening ports towards cockpit in the aft cabins (1 per cabin)
- Opening ports towards side-deck in the aft cabins (1 per cabin)

Options

- Folding pulpits seating
- Lifeline gates with removable access ladder
- Teak side-decks
- Rubrail for hull protection
- Mooring kit 6 fenders and 4 docklines
- Anchoring kit with Delta 20 kg / 44 lbs, 32 m (104') of 10 mm chain and 45 m (147') line
- Sunbed Sunbrella® Oyster on the foredeck

SAIL LOCKER

Standard

- Access via lockable deck hatch
- Access ladder in stainless steel

LIGHTING

Standard

- Full LED interior lighting

ELECTRICAL

Standard

- Main 12V electrical panel at the chart table
- 12V Circuit for house and engine system
- Domestic battery bank capacity 3 x 115 A/H 12V
- Engine start battery capacity 1 x 120 A/H 12V
- 12V engine alternator: 125A
- Positive and negative battery switch 12V in the aft cabin

Options

- Lithium domestic battery bank 3 x 90 A/H 12V
- USB plug in each cabin
- Inverter 12V > 220V 2000W enable to use 220V appliance from the domestic battery bank
- Generator Onan 7.5 KW 230V 2400 rpm, located at the transom

PLUMBING

Standard

FRESH WATER

- "Heavy-duty" water pump (19 l/5US gal/mn), accumulator tank for consistent water pressure
- Roto moulded tank: 400 L / 87 US gal, under the aft cabin berth
- Roto moulded tank: 240 L / 53 US gal, under the aft cabin berth
- Tank gauges (1 per tank)
- Tank manifold with selector valves
- Water boiler 40 L / 11 US gal connected to the engine and 220 V circuit
- Hot and cold cockpit shower on transom

GREY AND BLACKWATER

- Automatic electrical shower self-activating
- Large bowl marine Toilets
- Black water tank 50 litres / 13US gal, with gravity drain and deck fitting (forward and port aft heads)
- Black water tank 80 litres / 21US gal, with gravity drain and deck fitting (aft starboard head)

BILGES DRAINAGE

- Electric bilge pump located in bilge area with activation via switch at electrical panel
- Dual-action manual bilge pump located in the cockpit, with separate hose from primary bilge pump

GAS

- Gas leakage detector

Options

- Electric Quiet-Flush toilets, on fresh water circuit, in place of manual toilets
- Water intake in the cockpit. Enable to connect the fresh water circuit directly to the shore

ENGINE

Standard

- Latest-generation Common Rail engine with reduced emissions and consumption
- Yanmar Engine 4JH57CR Sail Drive - 57 CV / 42 KW - Alternator 125A
- Engine panel oriented toward helmsman, located on the cockpit table. Throttle at helm station
- Insulation: Foam 40 mm, with fire retardant film
- Built-in muffler, air ventilation and stainless steel exhaust fitting
- Fixed 3 blade propeller
- Ventilation system extractor fan located near the engine, benefiting from the insulation of the engine room. Outlets vents at the back of cockpit
- Roto moulded fuel tank (240 L / 63 US gal) located under the aft cabin berth, fuel / water separator
- Access behind steps to engine compartment and from aft cabins

Options

- Yanmar Engine 4JH80CR Sail Drive - 80 CV / 59 KW - Alternator 125A
- Yanmar Engine 4JH80CR 360 Docking - 80 CV / 59 KW - Alternator 125A
- Extra fuel tank 240 L / 63 US gal, instead of a fresh water tank underneath the aft cabin berth
- Retractable bow thruster 6.3 kW 105 kgf (231.5 lbs) with a dedicated 12V battery bank and charger
- Retractable stern thruster 6.3 kW 105 kgf (231.5 lbs) with a dedicated 12V battery bank and charger
- Flex-o-fold 3 blade folding propeller

LAYOUTS

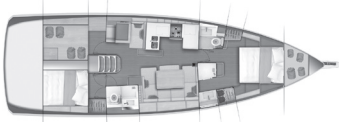

Version A
Forward Owner's cabin
1 aft cabin / 2 heads

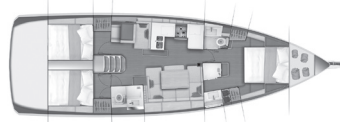

Version B
Forward master cabin
2 aft cabins / 2 heads



Version C (available in summer 2018)
2 forward cabins
2 aft cabins / 4 heads



Version D (available in summer 2018)
2 forward cabins
3 aft cabins / 3 heads

INTERIOR

Woodwork

- Fine Teak® interior woodwork laminated with solid wood trim, UV stabilized varnish
- Fully-upholstered hull sides and ceiling
- Oak laminate floorboards

Option

- Woodwork in alpi® Grey Cedar mat finish, open-pore varnish

Saloon

- Comfortable seating arrangement to starboard with view of sea through hull ports
- Hinged storage compartments under settee
- Large storage between the saloon and the companion way
- Bottles storage
- Large storage behind backrests
- Large table with 2 removable aluminium legs

Options

- "Deluxe" folding table on telescopic legs
- Convertible berth in saloon
- Central two-seat bench with storage

Chart table

- Large chart table with leatherette worktop, opening compartment for laptop computer
- Book shelves
- Sofa in vis à vis at the chart table
- Multiple storage for telephone, keys...
- Large storage space under electrical panel for books and other navigation equipment, storage underneath the seat
- Bicolour reading light
- Ergonomic seat, seaworthy
- Opening port above the chart table

Galley

- U shape galley located on port side, with view on the sea
- Counter top in Corian®, with fiddles
- Double stainless steel sinks with chrome fixtures
- Large drawer in the centre cabinet
- Soft-close, fully-extending drawers
- Sliding waste bin 26L / 7 US gal
- Open storage behind the galley
- 2 burner stove with protective handrail
- Fridge 190 L / 50 US gal with top opening

Options

- Push up micro wave
- Extra fridge drawer 75L / 20 US gal
- Extra freezer drawer 75L / 20 US gal
- Dishwasher

Comfort

- Cushions in high-density foam 140mm in the salon
- Premium mattresses

Options

- Cruisair® air conditioning working from generator or shore power with 3 units (40000 BTU in total)
- Pushed air heating system 11000W with outlets in each cabin and head

Forward Owner's cabin (versions A and B)

- Large passageway
- Large domestic size, rectangular berth, 200 cm x 160 cm / 6'6" x 5'2", with high density premium mattress
- Large dressing locker to starboard with hanging locker, full height drawer, opening cabinet and LED lighting
- Large hanging locker to port
- Central book shelves with space for the optional TV
- Lower locker with drawer, shoes storage and leatherette top finish
- 3 large drawers underneath the berth (2 drawers if air conditioning is selected)
- Side bed tables with leatherette
- Fully upholstered front bulkhead
- Large mirror in front of the cabin
- LED lighting
- 2 Opening deck hatches, for light and ventilation above the bed and 1 in the passageway
- 2 large fixed hull ports with sliding blinds
- Deck hatches with blind and bug screens
- Separate toilet compartment to port, with grp sink furniture, storage, hull port allowing sea view, opening deck hatch, indirect LED lighting, large marine toilet with manual pump
- En-suite owner's head compartment, with direct access from the cabin, grp sink furniture, drawer, opened storage shelves, hull port allowing sea view, opening deck hatch, indirect LED lighting, full height mirror. Separate shower compartment located in the centre of the boat for higher headroom, with its dedicated opening deck hatch and plexiglas door, shower, shower drain with automatic switch

Option

- Mattress battens
- Electric Quiet-Flush toilets, on fresh water circuit, in place of manual toilets

Aft cabins

- Large domestic size, rectangular berth 200 cm x 160 cm / 6'6" x 5'2", with high density premium mattress
- Hanging locker storage and shelf along hull

- LED Lighting
- LED reading lights
- 1 long fixed hull port, 1 large fixed cockpit window
- 1 opening port on coachroof, 1 opening port towards the cockpit, 1 opening port towards the side decks
- Blinds for each opening
- Access to tanks and technical area behind the engine
- Aft head: double access, from starboard cabin and saloon, grp sink furniture, storage with towel shelf, teak shelf with fiddle, large roof window, opening port for light and ventilation, indirect LED lighting, shower, shower drain with automatic switch, water inlet valve and connector underneath the sink, large marine toilet with manual pump, hook, large mirror, shower separated with a plexiglas door on versions A and B

Workshop (version A)

- Workshop located on port side behind the chart table, double access from the interior and from the cockpit
- LED lighting
- Large fixed hull window
- Access to the tank
- Direct access to electrical panels
- Lateral storage locker

Port side head (version C)

- Grp sink furniture, storage with towel shelf, teak shelf with fiddle, large roof window, opening port for light and ventilation, indirect LED lighting, shower, shower drain with automatic switch, water inlet valve and connector underneath the sink, large marine toilets with manual pump, hook, large mirror

Portside lateral cabin (version D)

- 2 bunk beds, hanging locker, reading LED light, locker underneath the inferior bed
- Opening deck hatch for ventilation, fixed roof windows

Forward twin cabins (versions C and D)

- Large rectangular berth 200 cm x 140 cm x 79 cm / 6'6" x 4'7" x 2'7", with high density premium mattress
- Removable bulkhead between the cabins
- Hanging locker
- Storage underneath the berth
- LED lighting
- Opening deck hatch with ventilation
- Large fixed hull windows with sliding blinds
- blinds and bugs screens for deck hatches

Forward heads (versions C and D)

- Grp sink furniture, storage, hull port allowing sea view, opening deck hatch for light and ventilation, indirect LED lighting, shower, shower drain with automatic switch, water inlet valve and connector underneath the sink, Large marine toilet with manual pump, hook

HEADROOM

Forward cabin	1,88 m / 6'2"	Galley	1,92 m / 6'4"
Aft cabin	1,91 m / 6'3"	Forward head	1,90 m / 6'3"
Companionway	1,98 m / 6'6"	Aft head	1,93 m / 6'4"
Saloon	2,00 m / 6'7"		



JEANNEAU

